

GAFC100 Series FR.L. combination

Specification

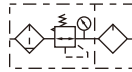

Reflux valve option is not available



Model		GAFC100M5	GAFC10006
Fluid		Air	
Port size [Note1]		M5	1/8"
Filtering grade		40μm or 5μm	
Pressure range		20~130psi(0.15~0.9MPa)	
Max. pressure		145psi(1.0MPa)	
Proof pressure		215psi(1.5MPa)	
Temperature range		-5~70°C(Unfreeze)	
Capacity of drain bowl		6CC	
Capacity of oil bowl		9CC	
Recommended lubricant		ISO VG 32 or equivalent	
Weight		158g	
Constitute	Filter & Regulator	GAFR100M5	GAFR10006
	Lubricator	GAL100M5	GAL10006

[Note1] NPT thread is available.

Ordering code



① Model	② Bowl material	③ Port size	④ Drain type	⑤ Type code	⑥ Pressure gauge	⑦ Filtering grade	⑧ Thread type [Note2]	⑨ Code of reflux valve
GAFC100: Ga100 Series FR.L unit	Blank : PC	M5: M5 06: 1/8"	Blank: Semi-auto drain+Manual drain	S: Standard L: Lower pressure [Note1]	Blank: Circular N: No gauge	Blank: 40μm W: 5μm	T: NPT(psi/bar)	Blank: Reflux valve is not available

[Note1] The working pressure range of lower pressure type is 0.15~0.4MPa(20~58psi) ;

[Note 2] Thread type means connecting thread and scales of pressure gauge while port size is M5.

Pressure and Flow chart

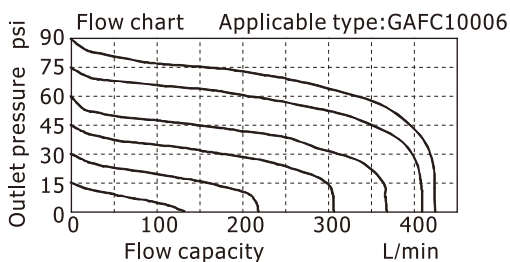
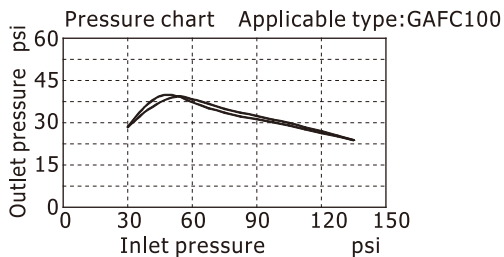

Dimensions

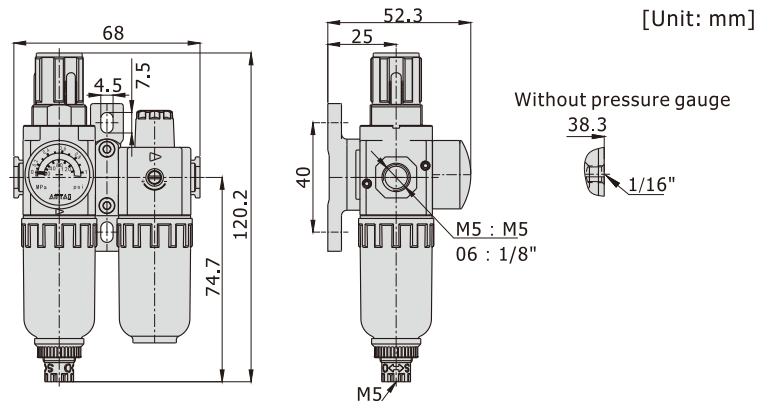

Inner structure

No.	Item
1	GAFR100 series filter & regulator
2	Bracket
3	GAL100 series lubricator

